

permittee, upon written notification by the township, shall, at his own expense, immediately take the necessary steps to place the work into conformance with such requirements or standards.

§ 109-5.8. Time limit for commencement of work.

If any work authorized by any permit under this article shall not have been commenced within six months after the issuance of such permit, the permit holder must relinquish such unused permit which shall thereupon become invalid. The permit fee under these circumstances will not be returned or applied toward any future permit.

§ 109-5.9. Inspection required prior to completion of work.

Within seven days of the completion of the rough grading of any such improvements and prior to the paving or installation of any stone, the applicant shall notify the Township Roadmaster or his designee that said rough grading has been accomplished. Within seven days of this date, the Township Roadmaster or his designee shall inspect the premises to determine the compliance with the plans and the grades existing on the driveway. No further construction activities shall be performed on the driveway prior to inspection and approval by the Township Roadmaster or his designee.

§ 109-5.10. Time limit for completion of work.

All driveway improvements shall be completed within 90 days of the approval of the rough graded driveway by the Township Roadmaster or his designee; subject, nevertheless, to extension granted by the Board of Supervisors due to truly extraordinary circumstances, including but not limited to extended inclement weather making work impractical or impossible.

§ 109-5.11. Notification of completion of work.

Upon completion of any work authorized by the permit, the holder of such permit shall report to the Township Roadmaster or his designee, in writing, within 10 days of the date of completion. The Township Roadmaster or his designee shall make a final inspection within seven days of notification to determine compliance with permit specifications.

§ 109-5.12. Design standards.

- A. Angle of driveway approaches. Driveway approaches used for two-way operation shall be positioned at right angles (90°) to the street or as near thereto as site conditions permit. (See Figure Nos. 3 and 4.³)
- B. Driveways adjacent to intersections.

³ Editor's Note: Figure Nos. 3 and 4 are included at the end of this chapter.

- (1) There shall be a minimum forty-foot distance between the street right-of-way line of the intersecting street and the beginning of the radius of the first permitted driveway or access drive. (See Figure No. 6.⁴)
- (2) This offset distance shall be considered the minimum distance; in the case of medium- and high-volume driveways, the Township Engineer may require additional offset distance as needed to preserve safe sight distance and traffic flow.

C. Additional offsets.

- (1) Driveways may not enter a public street:
 - (a) Within five feet of a fire hydrant.
 - (b) Within 25 feet of another driveway on the same property.
 - (c) Within three feet of an adjoining property line.
- (2) All distances shall be measured beginning where the driveway radius meets the cartway.

D. Curbing. The township may require the permittee to install curbing to facilitate drainage, or to prohibit vehicle encroachment upon the sidewalk area, or as otherwise deemed necessary by the township. Where curb installation is required, the Township Engineer shall review and approve both curblines and grade prior to construction.

E. Sight distance. Driveways shall be located at a point within the property frontage limits which provides at least the minimum sight distance computed in accordance with the criteria listed in the Jackson Township Required Sight Distance Table (Appendix A⁵). The sight distance shall be measured along the center line of the street cartway, from a height of 3.75 feet to the height of an object which is 0.5 foot above the street cartway. The point shall be 15 feet from the edge of paving on the intersected street. If sight distance requirements as specified in Appendix A cannot be met, the township may:

- (1) Prohibit left turns by exiting vehicles;
- (2) Restrict turning movements to right turns in and out of a driveway;
- (3) Require installation of a right turn acceleration lane or deceleration lane;
- (4) Require installation of a separate left turn standby lane;
- (5) Require alteration of the horizontal or vertical geometry of the street; or
- (6) Deny issuance of the permit.

F. Clear sight triangle. Proper sight lines must be maintained at all street intersections. Clear sight measured along street center lines from their point of junction shall be provided at all intersections, and no building, structure, grade or planting higher than three feet above the center line of the street shall be permitted within such sight triangles. The following clear sight distances shall apply:

⁴ Editor's Note: Figure No. 6 is included at the end of this chapter.

⁵ Editor's Note: Appendix A is included at the end of this chapter.

Class of Street	Distance Along Major (feet)	Distance Along Minor (feet)
Arterial	150	150
Collector	150	150
Minor	75	75
Driveway	75	25

G. Grade of driveway.

- (1) All driveways shall be constructed so as not to impair drainage within the right-of-way, alter the stability of the improved area or change the drainage of adjacent areas.
- (2) Where a drainage ditch or swale exists deeper than 10 inches, the permittee shall install a pipe of adequate size under the driveway, as approved by the Township Engineer. Wherever possible, pipes under driveways shall be located outside of the township right-of-way.
- (3) No driveway shall be permitted to discharge stormwater directly to the street, nor shall any driveway obstruct the roadside swale. In lieu of a pipe, the permittee may be required to construct a swale across the driveway to permit the unimpeded flow of stormwater past the driveway.
- (4) Cuts. Where a driveway enters a bank through a cut, unless a retaining wall is used, the slope of the cut may not exceed 50% in slope within 25 feet of the point at which the drive intersects the street right-of-way. The height of the bank must not exceed three feet within 10 feet of the roadway. (See Figure No. 2.⁶)
- (5) Grade requirements in curbed and uncurbed streets shall conform to Figure No. 1.⁷

H. Paving. The portion of a driveway within a street right-of-way, and for a distance of 25 feet beyond that right-of-way, shall be paved with a concrete, bituminous or other paving material acceptable to the Township Engineer to prevent gravel or other loose material from being carried onto the street. Materials used in the construction of driveways within the public right-of-way shall conform to the Jackson Township Construction and Materials Specifications.

§ 109-5.13. Penalties for violation; enforcement.

- A. Any violation of this article shall be enforced by equity suit for specific performance in the Court of Common Pleas. The owner of the property shall be responsible for all expenses, including but not limited to court costs, engineering and attorney's fees incurred by the township.

⁶ Editor's Note: Figure No. 2 is included at the end of this chapter.

⁷ Editor's Note: Figure No. 1 is included at the end of this chapter.

APPLICATION FOR MINIMUM USE DRIVEWAY

A Minimum Use Driveway is a residential or other driveway which is normally used by not more than 25 vehicles per day.

READ INSTRUCTIONS ON REVERSE

APPL. NO. _____

Applicant/Property Owner	
Address	
Post Office	Zip Code
Phone	

LOCATION OF PROPOSED DRIVEWAY:

Subdivision Name _____

Street Name _____

Name of Nearest
Intersecting Street _____

Distance (in feet) to
Nearest Intersection _____

APPLICATION IS MADE TO:

☐ Construct a New Driveway ☐ Alter an Existing Driveway

Date Work Scheduled to Begin _____
Date Work Scheduled to be Completed _____

NOTE: Sight distance shall be measured from a point 3.75 feet above the centerline of the street to a point 0.5 feet above the centerline of the proposed driveway.

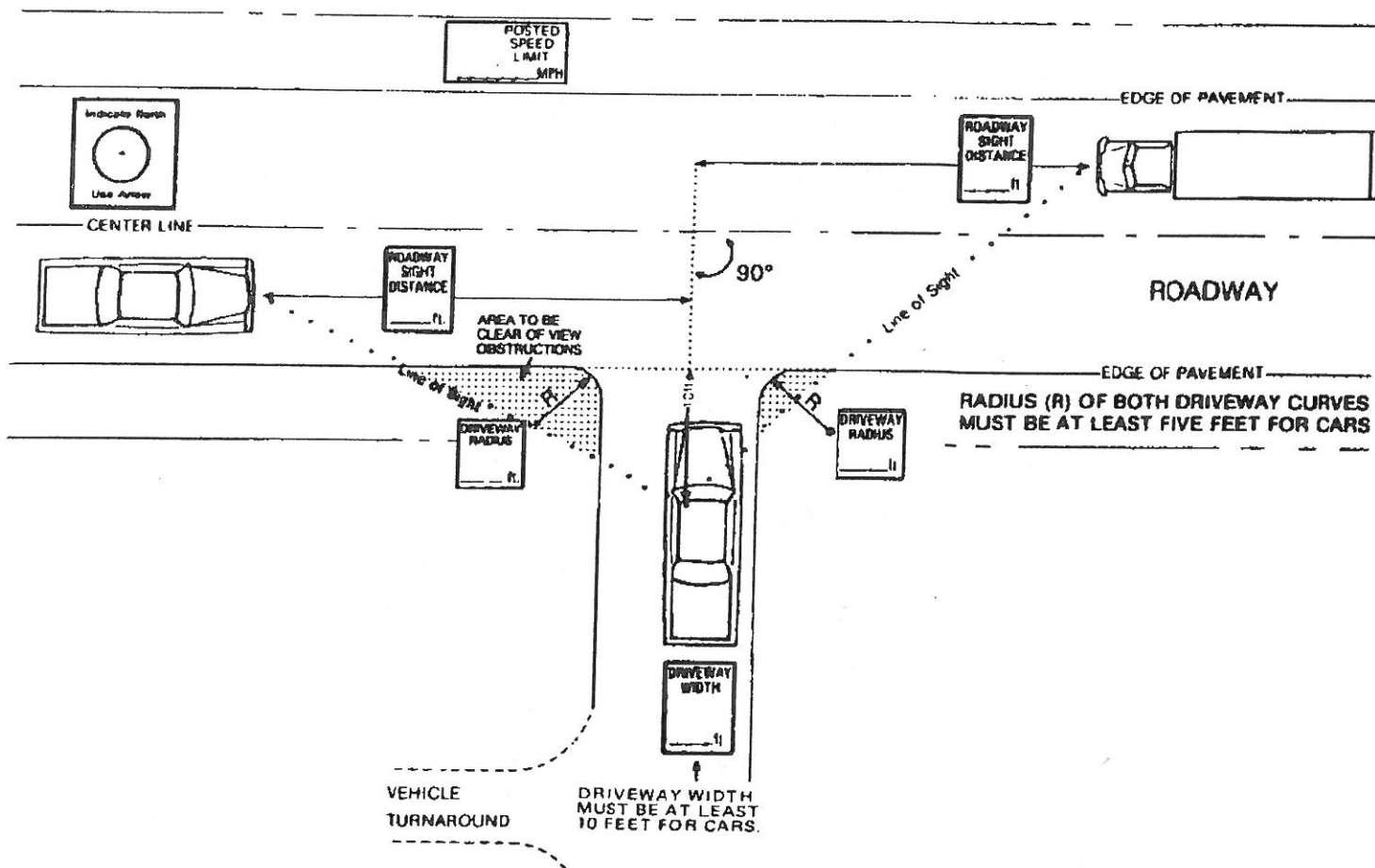

The Applicant certifies that all statements contained herein are true and correct.

By: _____ Date: _____ Fee Paid: _____
Permit Issued By: _____ Date: _____

§ 133-34 Driveways

Width. Within 10 feet of the street right of way, driveways may not exceed 20 feet in width.

Number. The number of driveways may not exceed two per lot on any one street frontage.

Offsets. Driveways may not enter a public street within:

- (1). Forty feet of the street right-of-way line of any intersecting street.
- (2). Five feet of a fire hydrant.
- (3). Twenty-five feet of another driveway on the same property.
- (4). Three feet of an adjoining property line.

Sight Distances. A driveway must be located in safe relationship to sight distance and barriers to vision as provided by PennDOT standards for safe stopping sight distances.

Slope. The driveway may not exceed a slope of 8% within 25 feet of the street right-of-way line.

Paving. The portion of a driveway within a street right-of-way and for a distance of 25 feet beyond that right-of-way shall be paved with a concrete, bituminous, or other paving material acceptable to the Township Engineer to prevent loose material from being carried onto the street.

Cuts. Where a driveway enters a bank through a cut, unless a retaining wall is used, the shoulders of the cut may not exceed 50% in slope within 25 feet of the point at which the driveway intersects the street right-of-way. The height of the bank must not exceed three feet within 10 feet of the roadway.

All lots must have a separate driveway located on the lot which the driveway serves. i.e., one driveway may not serve more than one lot, except for preexisting, land-locked lots of record.